

A920 Launcher

The 'Launcher' is displayed once your A920 has completed its start-up process. It allows users to configure Wi-Fi or cellular settings items before loading the Payment application.

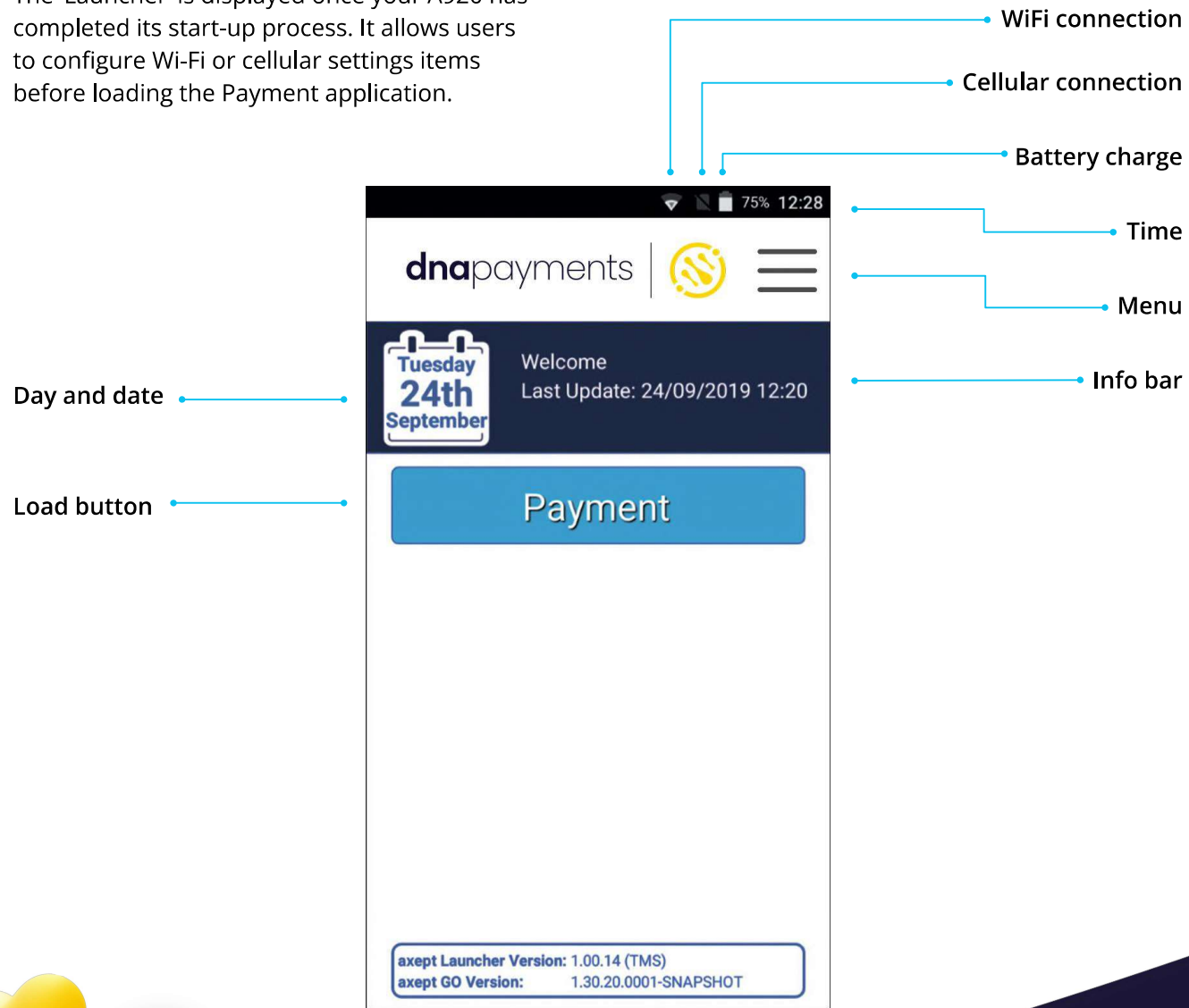

Using WiFi

Your A920 terminal can support connections to both 2.4Ghz and 5Ghz Wi-Fi networks, and you can program it with multiple network configurations for devices used in more than one location. The A920 will always select Wi-Fi as its primary connection type, where present, with a cellular connection used as a backup. To configure your Wi-Fi connection, use the following steps:

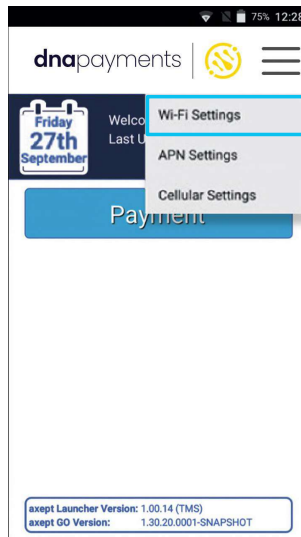

1

Select the menu icon on the main A920 Launcher screen and choose **Wi-Fi Settings**.



2

The Wi-Fi module will be disabled by default, as shown by the Off message in the header bar. To enable Wi-Fi, simply press the slider on the right-hand side of the screen.



Using Wi-Fi (continued)

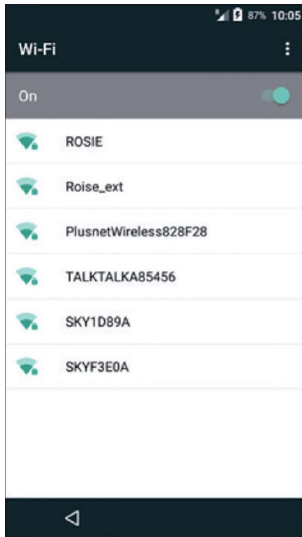

3

The terminal will now scan for the available networks, and once the scan is complete, a list is displayed.

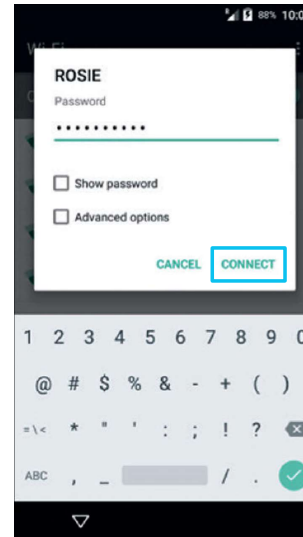

4

Choose your desired network and enter the password once prompted. When you've completed this, press **Connect**.

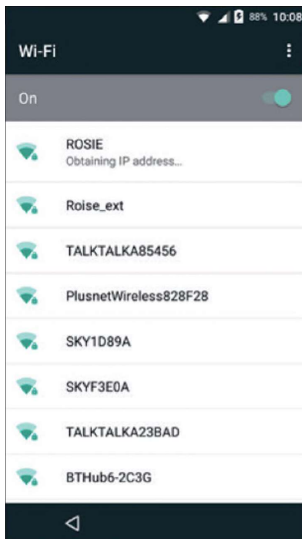

5

The connection process will now begin.

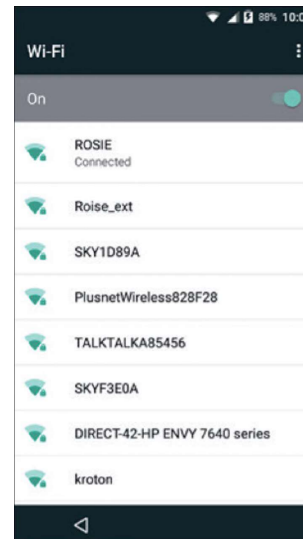

6

Once completed, your terminal will finish the connection using DHCP and return you to the **Wi-Fi** menu displaying the status of **Connected** against your desired network.

Using Wi-Fi (continued)

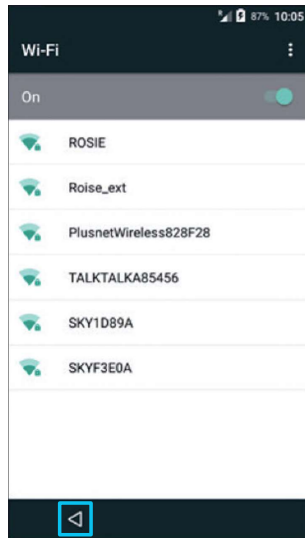

7

Select the left arrow at the bottom of the screen to return to the A920 Launcher.

Your A920 also lets you use static IP details. Please refer to the full The A920 User Guide for more information if this is needed.